

BALCONY RAILING
OSLO
TOP
MOUNTED
INSTALLATION MANUAL

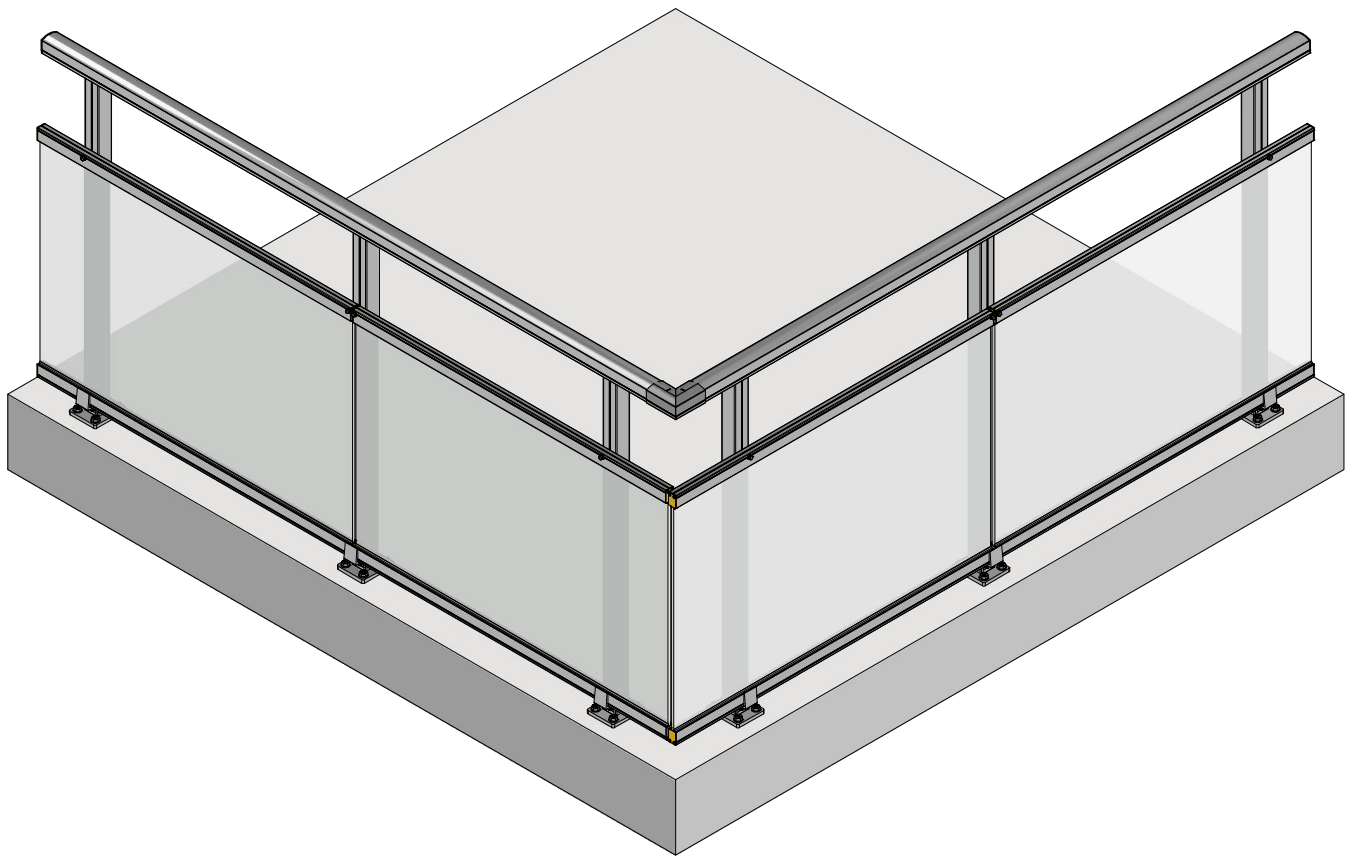

NECESSARY AND ADDITIONAL HELPFUL ITEMS FOR INSTALLATION:

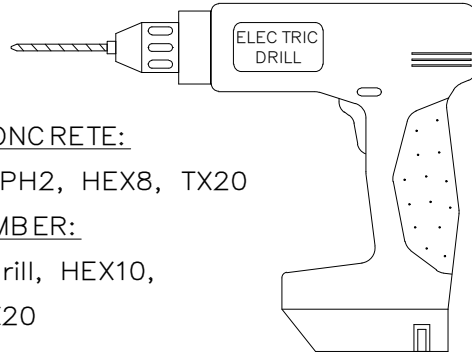

Drillbits for CONCRETE:

SDS plus M8, PH2, HEX8, TX20

Drillbits for TIMBER:

Ø6mm wood drill, HEX10,

TX40, PH2, TX20

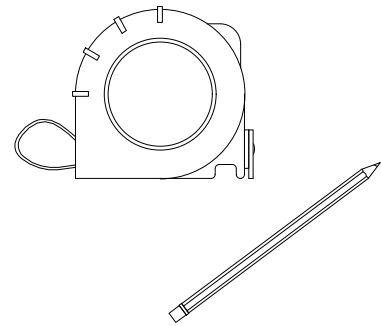

Measuring tape & pencil

Electric drill for TIMBER
Hammer drill for CONCRETE



Soapy water spray
(Optional)

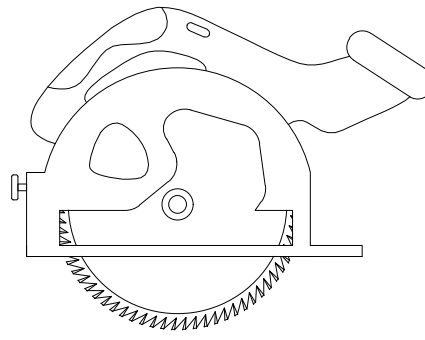

Angular saw
cold cut

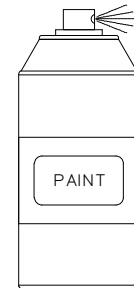

Repair paint
(Optional)

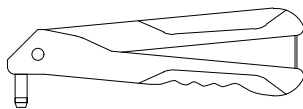

Riveting pliers

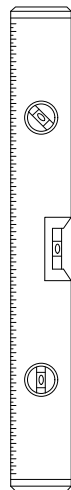

Level

CAUTION

READ THE WHOLE INSTALLATION MANUAL BEFORE STARTING.

- It is easy to scratch and/or break glass panels, handle with care, use cut resistant gloves.
- Railings are powder coated, paint can be damaged if profiles are left on uneven surfaces and not handled properly.
- Balcony railing installations have to follow the requirements set by a country's legislation. Innore takes no responsibility of damage and casualties that have occurred due to non-compliant installation.
- Do not install during windy weather conditions. Glass railings are heavy in weight and bear a lot of wind due to a large surface area.
- Safety is number one priority when dealing with heights, always use personal protective equipment.

LIST OF DIFFERENT COMPONENTS:

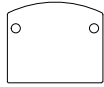

Handrail 51X43 endplate

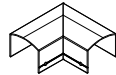

Handrail 51X43 corner

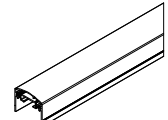

Handrail 51X43



Handrail 82x35 endplate

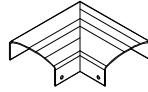

Handrail 82X35 corner

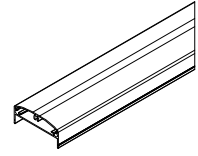

Handrail 82X35

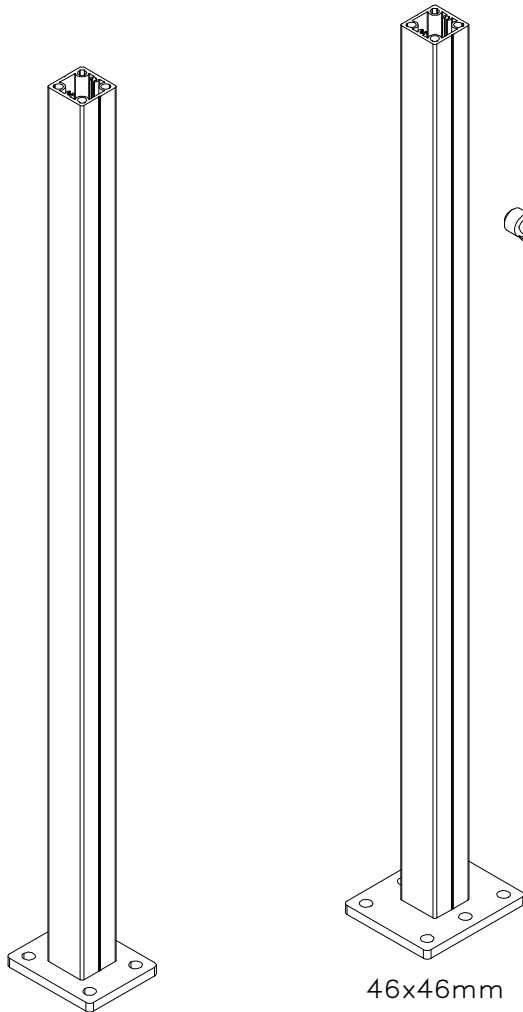

46x46mm

46x46mm

Column with baseplate,
Column with baseplate, connection to timber
connection to concrete

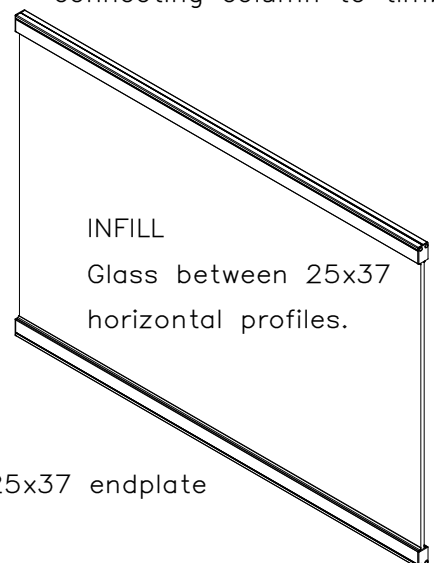
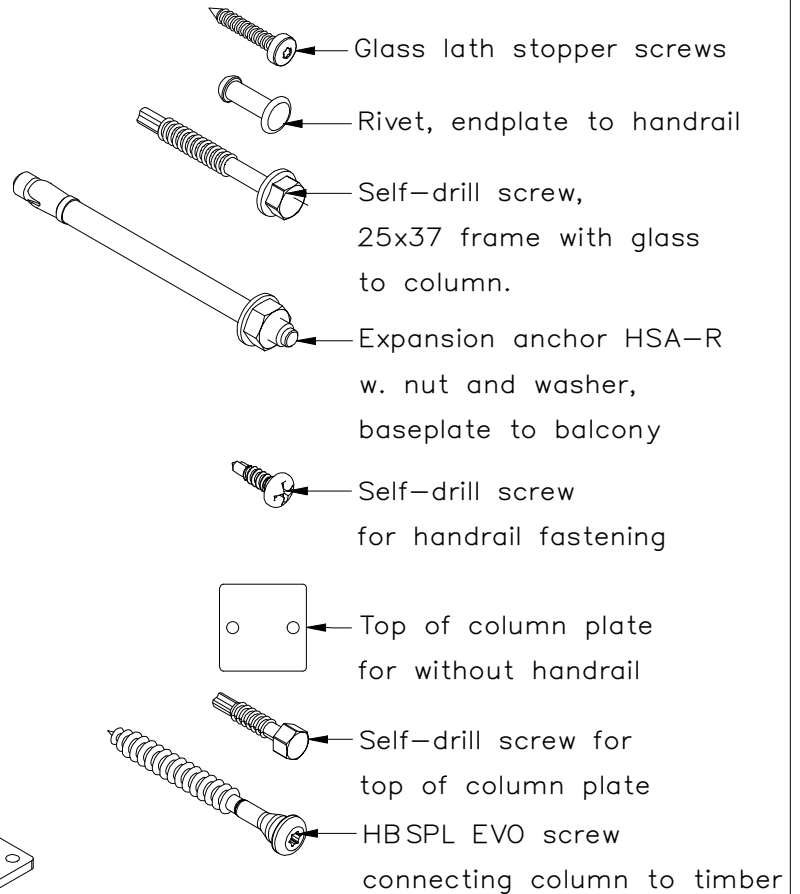

INFILL

Glass between 25x37
horizontal profiles.

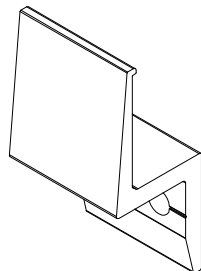
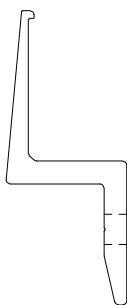

Z-bracket with
connection to column



25x37 endplate

OVERALL REGULATIONS

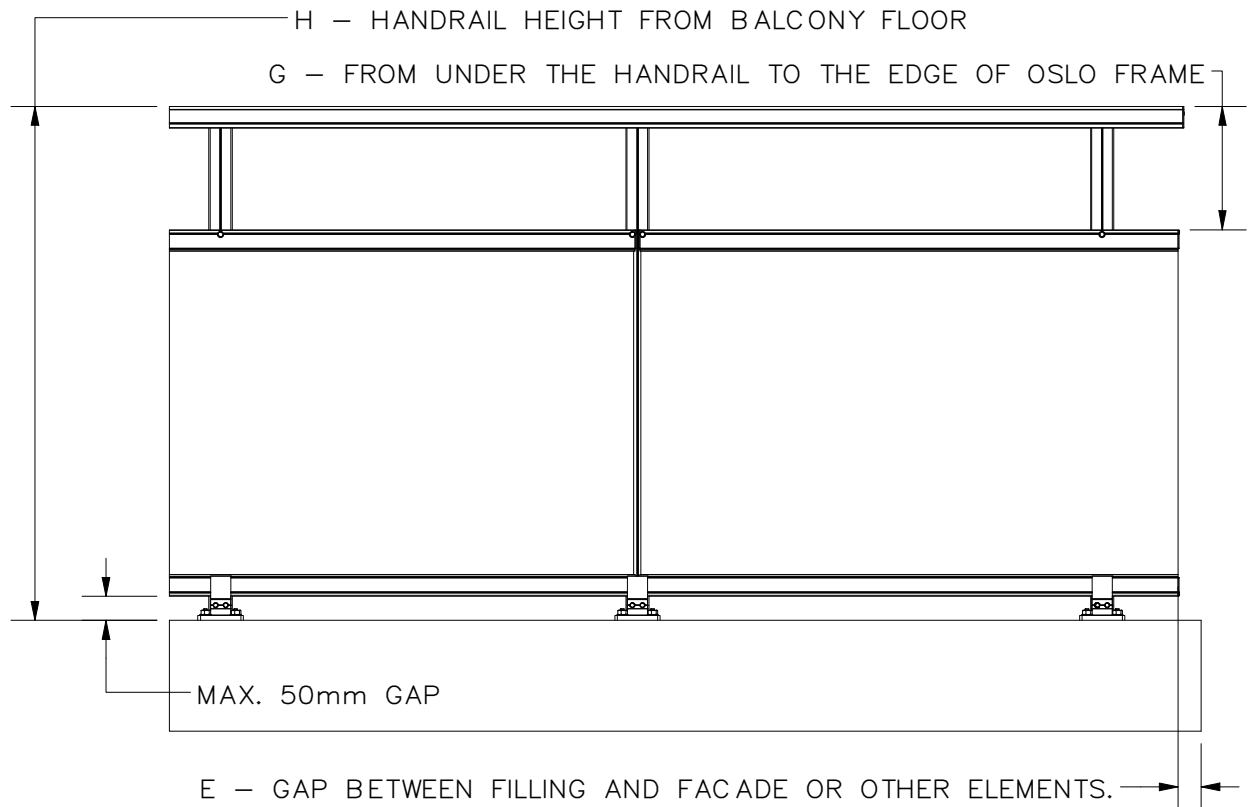

If you ordered from the e-store, you need to cut the column to the correct length.

To calculate the correct length:

1. Measure your infill height.
2. Add 50mm for the Z-bracket.
3. Add the infill height.
4. Include the G measurement required in your country.

The sum of these values gives you the column height.

If your balcony floor is raised (not at the same level as the column fixing point), measure the maximum gap (up to 50mm) from that surface and adjust accordingly.

	Norway	Finland	Estonia	Sweden	Denmark	Germany
G (mm)	MAX 250*	<200	<200	<110 AND >230	MAX 250	MAX 250
E (mm)	MAX 100	MAX 50	MAX 50	MAX 50	MAX 100	MAX 100
H (m)	1 or 1.2	1 or 1.2	1 or 1.2	1.1	1 or 1.2	1 or 1.2

* Norway has a regulation difference: G – From TOP of handrail to the edge of oslo frame

HANDRAIL AND INFILL OPTIONS FOR BOTH BASE STRUCTURES – CONCRETE & TIMBER.

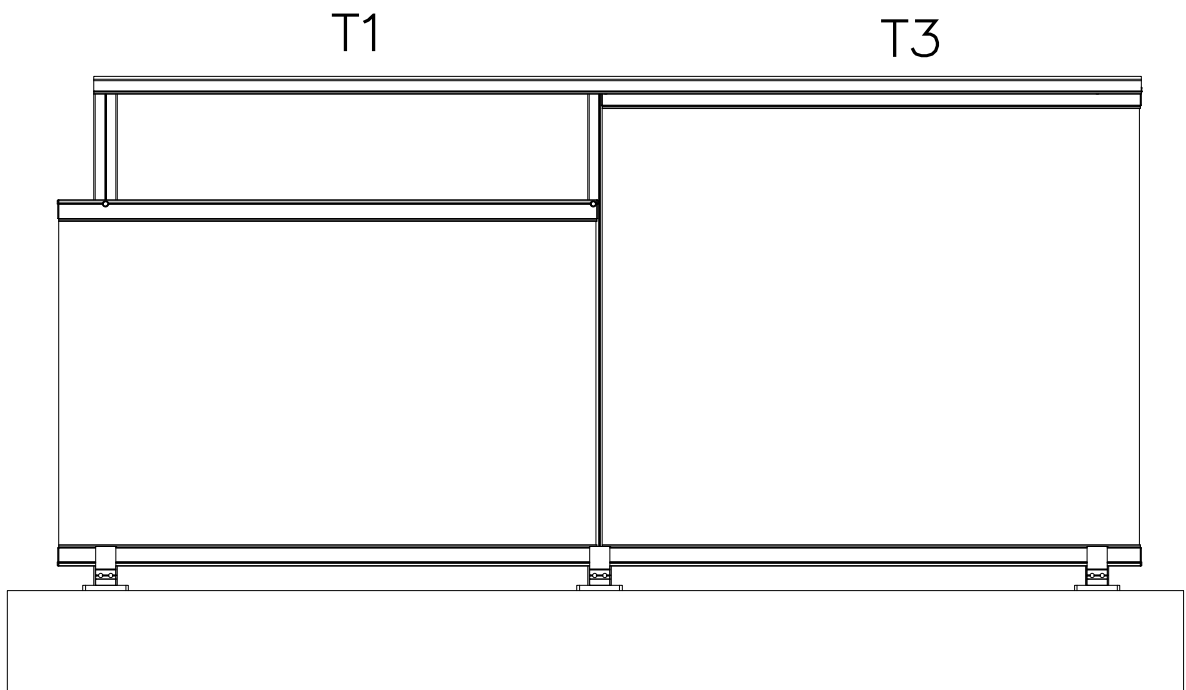

T1 OPTIONS:

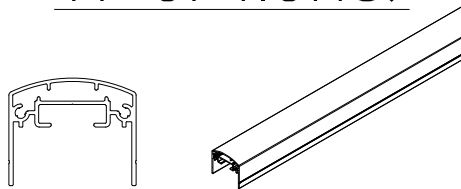

Handrail 51X43

T3 OPTIONS:

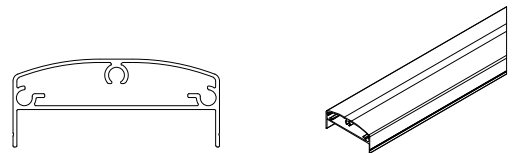

Handrail 82X35

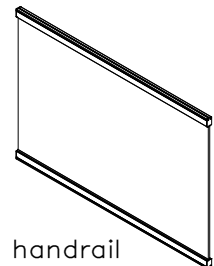

SEE STEP 6 FOR FURTHER INFORMATION ABOUT DIFFERENT TYPES OF HANDRAILS.

Without separate handrail option. Column has a endplate, 25x37 profile itself is the handrail.

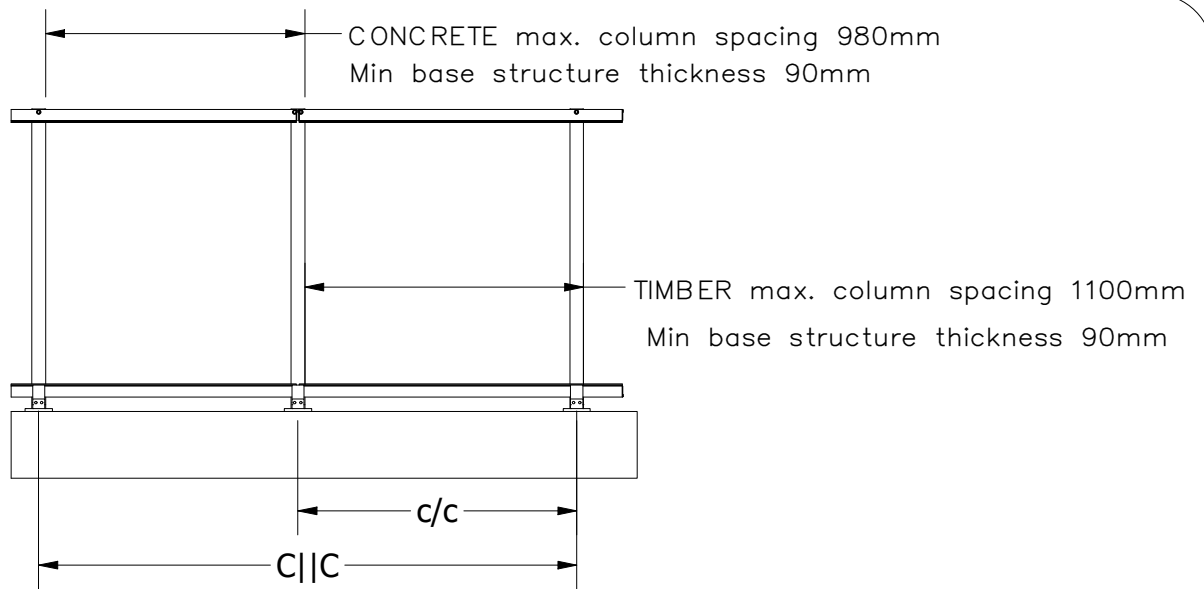

STEP 1. CALCULATE DESIRED COLUMN
SPACING (c/c). $c/c = \frac{C||C}{\text{DESIRED SPACING NUMBER}}$

Max. column spacing		
Heigth (m)	Concrete (mm)	Timber (mm)
1	980	1100
1.2	820	950

*These apply to suburban terrain and villages and city environments considering wind load. For opened areas such as coastal areas and large areas with low vegetation, please contact Innore or your local structural engineer for further analysis of column spacing.

STEP 2. MARK THE DRILL HOLES TO BALCONY

TOP MOUNTED TIMBER – Minimum 10D from center of the screw to the edge of balcony. D = Fastener diameter. Ø10 has to have 100mm from edge.

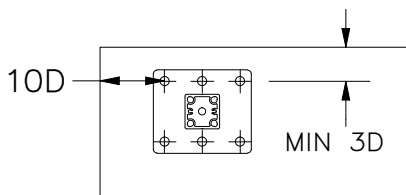

TOP MOUNTED CONCRETE – Minimum 50mm with M8 anchors and 70mm with M10 anchors from edge of balcony.

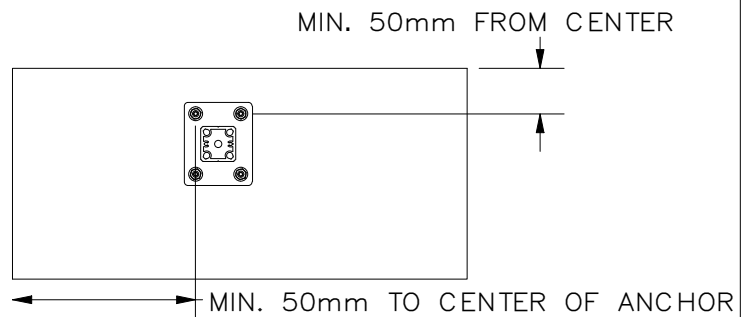

ROTHOBLAAS HBS
PLATE EVO SCREW
DATASHEETS AND
INFORMATION



HILTI HSA-R WEDGE
ANCHOR
DATASHEETS AND
INFORMATION

INNOR

PRODUCT:
OSLO TOP

SHEET NAME:
MEASUREMENTS – TOP MOUNTED

DATE:

PAGE:
6

VERSION:

FORMAT:
A4

STEP 3. DRILL THE HOLES AND FASTEN THE COLUMNS

TOP MOUNTED TIMBER

1. Predrill $\varnothing 6$ holes.
2. *In case you are going through waterproof layer, use roof sealant before fastening.*
3. Fix base plate with column to ground with correct fasteners according to project.
4. Check with level before fixing tight.
5. Check that the column is securely fixed.
6. Proceed with the installation of the remaining columns.

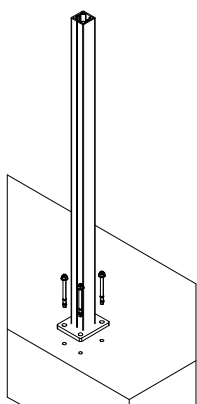

FIX COLUMN WITH BASE PLATE
WITH CORRECT FASTENERS

TOP MOUNTED CONCRETE

1. Mark the drill bit with a marker to set the correct drilling depth (min. 65 mm for expansion anchor).
2. Drill $\varnothing 8$ holes.
3. Clean the holes with a vacuum cleaner.
4. Hammer the anchors into the drilled holes.
5. Place the column with the base plate onto the anchors.
6. Make sure the column is correctly positioned, use a level.
7. Tighten the nuts by hand first, then use a wrench (this will expand the bottom part of the anchor).
8. Check that the column is securely fixed.
9. Proceed with the installation of the remaining columns.

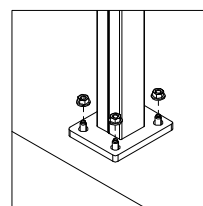
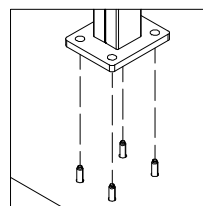
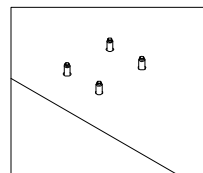
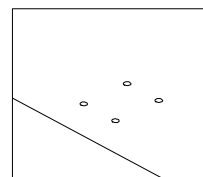
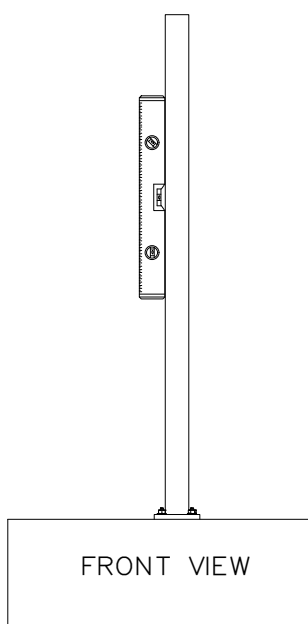

STEP 4. FIX INFILL MOUNTING PROFILE TO COLUMNS.

1. Fix the z-bracket that carries infill to column. Check overall regulations on page 4 to get the correct height.

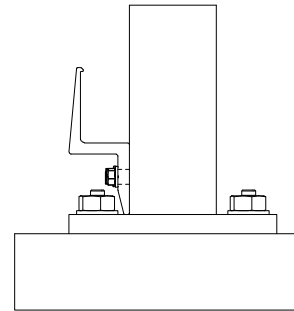
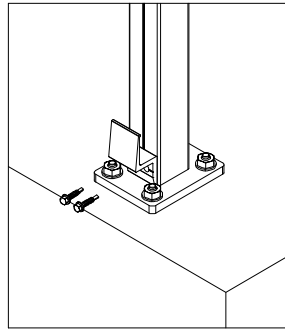
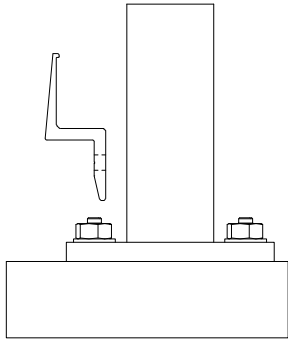

STEP 5. INSTALL INFILL TO COLUMNS.

Glass with gaskets and 25x37 profile have already been pre-cut and put together according to ordered dimensions.

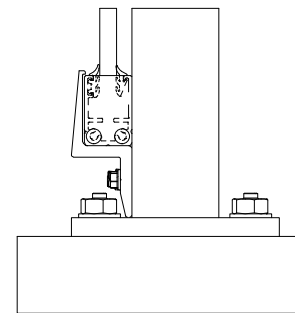
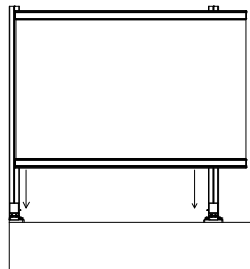
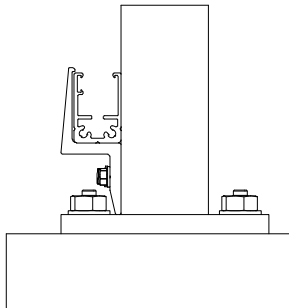

It is recommended to slide in the the frame with glass from the top, it fixes with a click. Infill must be fastened at the top with self-drilling screws. Pay attention to not over tighten the screws. Max torque 8Nm.

It is necessary to use 2 glass fixing profile stopper screws per 1 infill. Both as close to column as possible to eliminate the movement of infill.

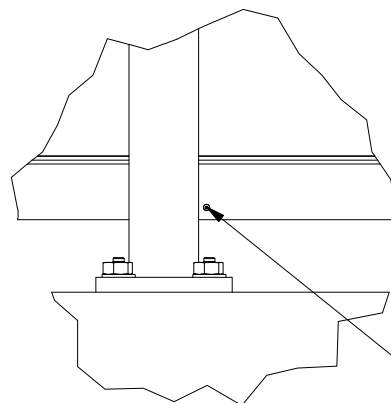
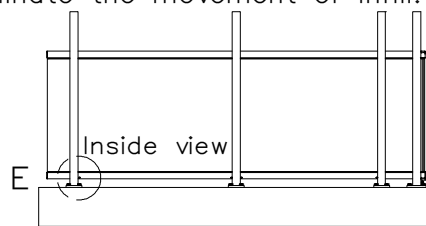
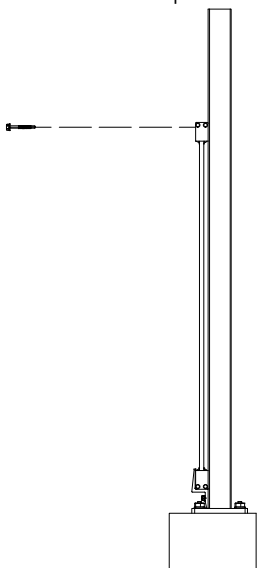

Glass fixing profile stopper screw

DETAIL E

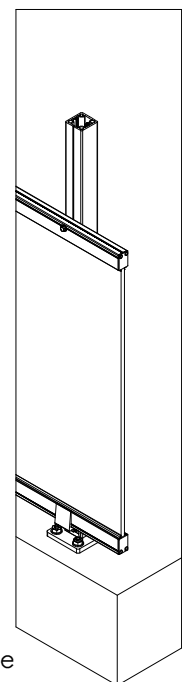

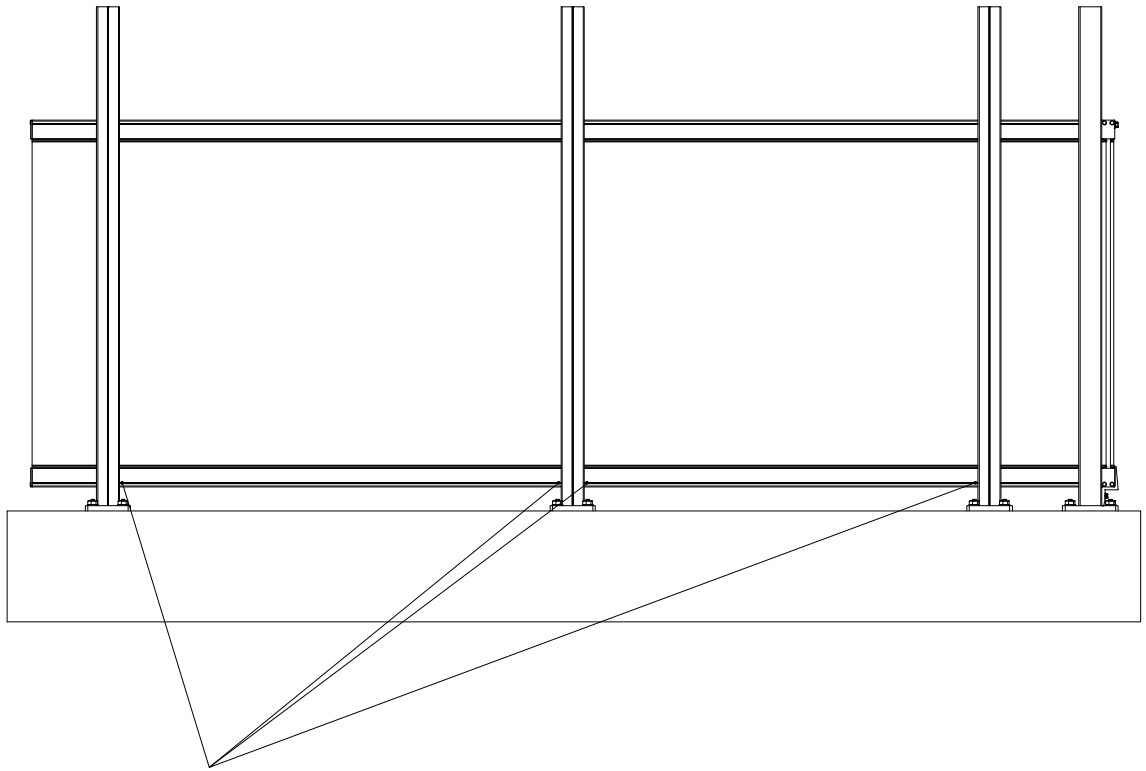

Glass fixing profile stopper screw positions.

Screws are to be installed from inside the balcony as close to the column as possible.

Continuation should be made in the center of the column.

Make sure the condensation holes face downward during installation.

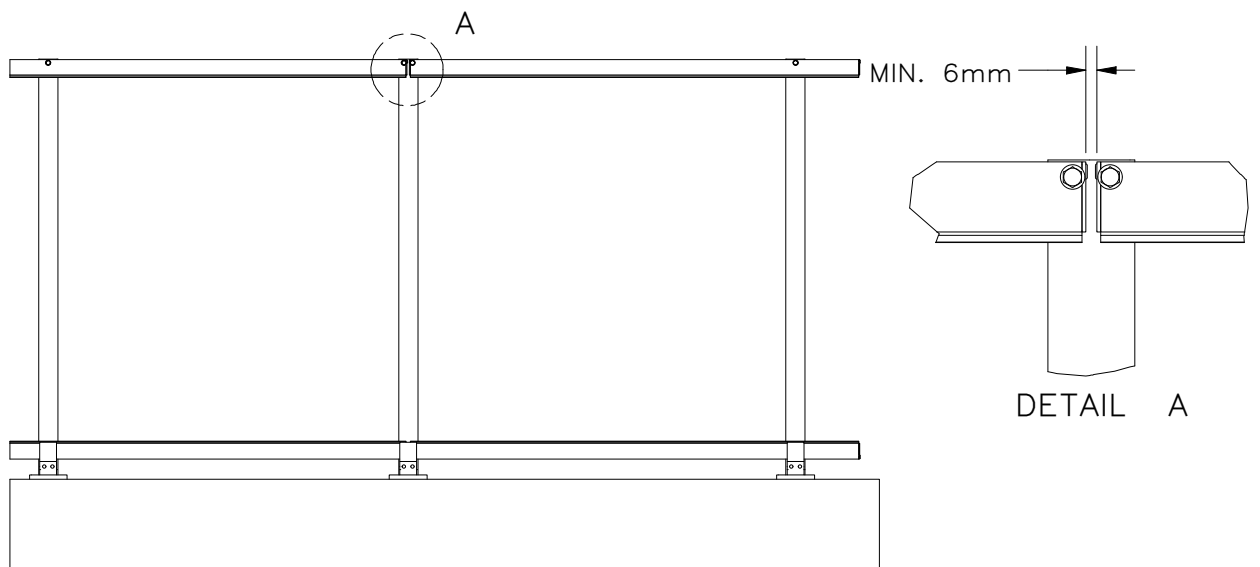

STEP 6. CUT AND FIX THE HANDRAIL

HANDRAIL 51X43

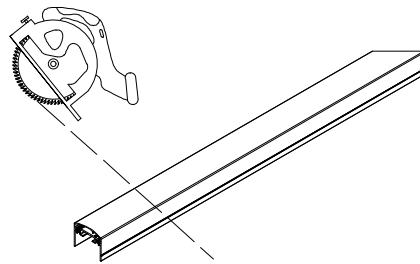
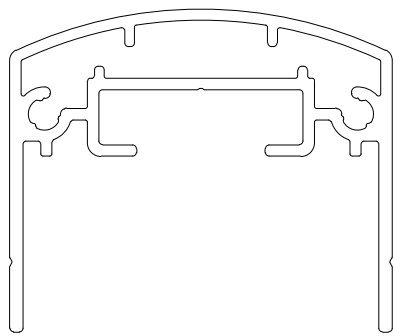

Cut the handrail to desired length.

Fasten handrail to columns using self-drilling screws.

Optional endplates are installed with rivets.

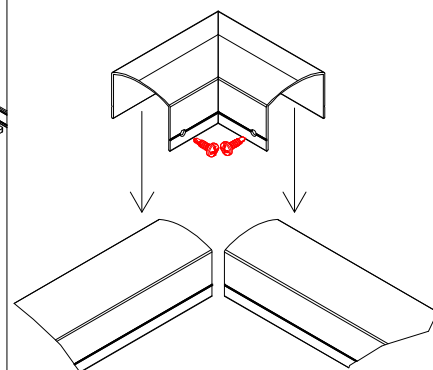
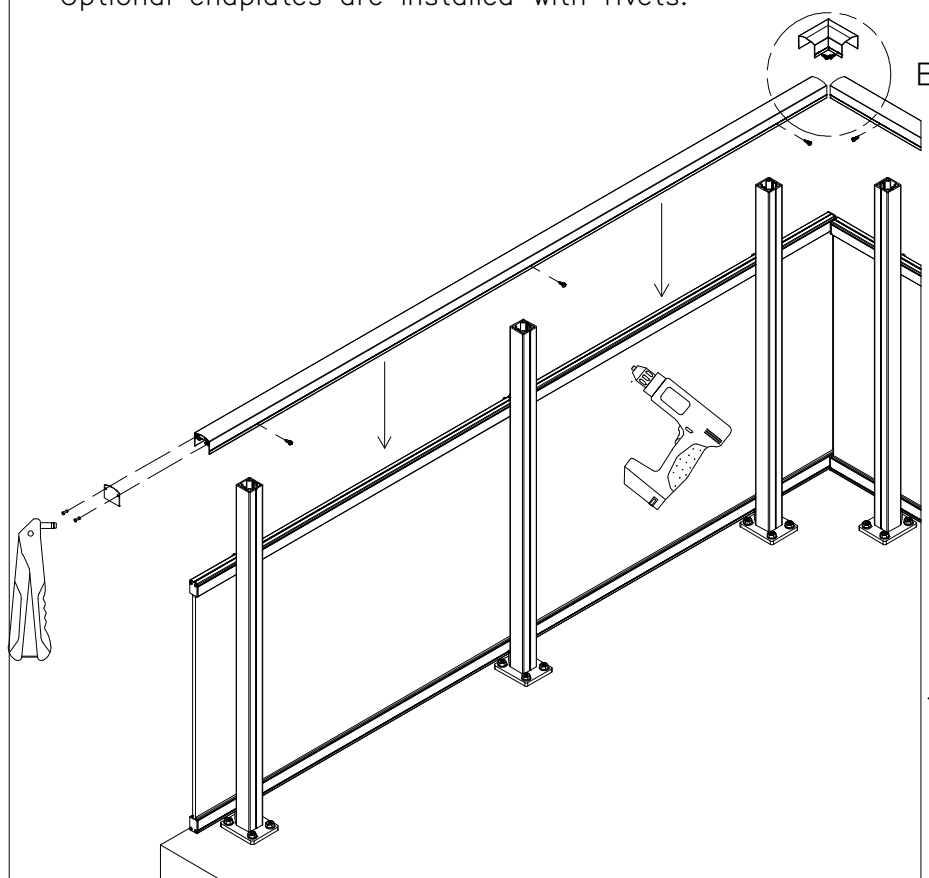

DETAIL B

The corner piece is fastened to the handrail with self drilling screws. In case the corner piece overlaps a column, secure both the corner and the handrail to the post by the same screw.

STEP 6. CUT AND FIX THE HANDRAIL

Cut the handrail to desired length.

Fasten handrail to columns using self-drilling screws.

Optional endplates are installed with rivets.

HANDRAIL 82x35

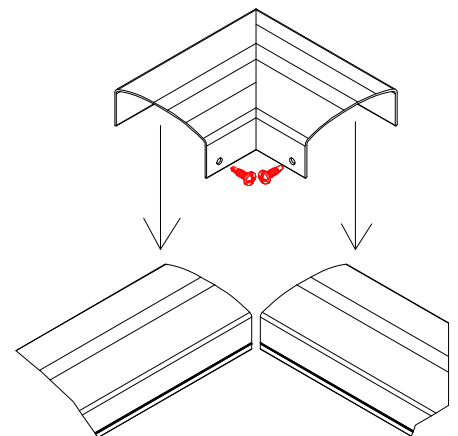
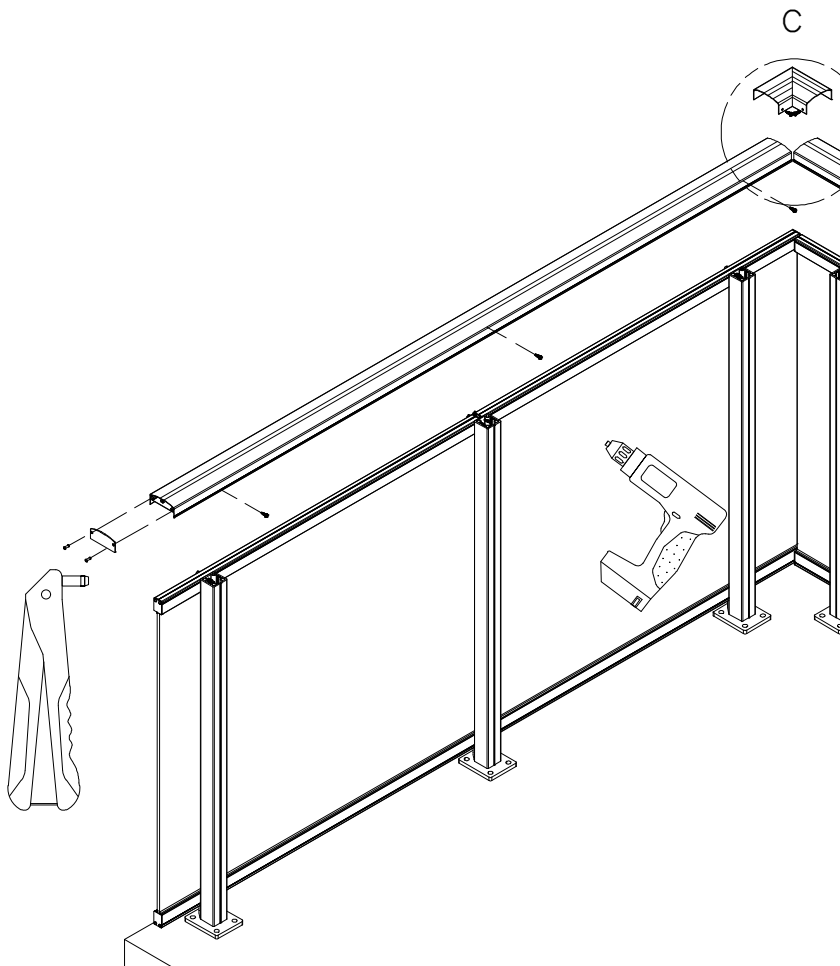
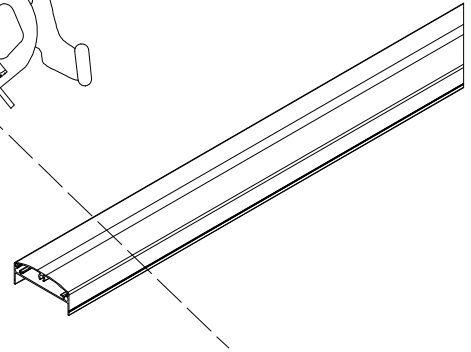
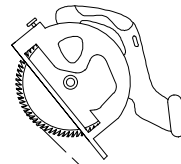
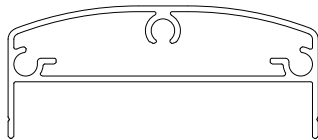

DETAIL C

The corner piece is fastened to the handrail with self drilling screws. In case the corner piece overlaps a column, secure both the corner and the handrail to the post by the same screw.

STEP 6. WITHOUT HANDRAIL OPTION

This option does not have a handrail, instead it has 2x46x46mm endplates fastened with self drilling screws to the top of the columns.

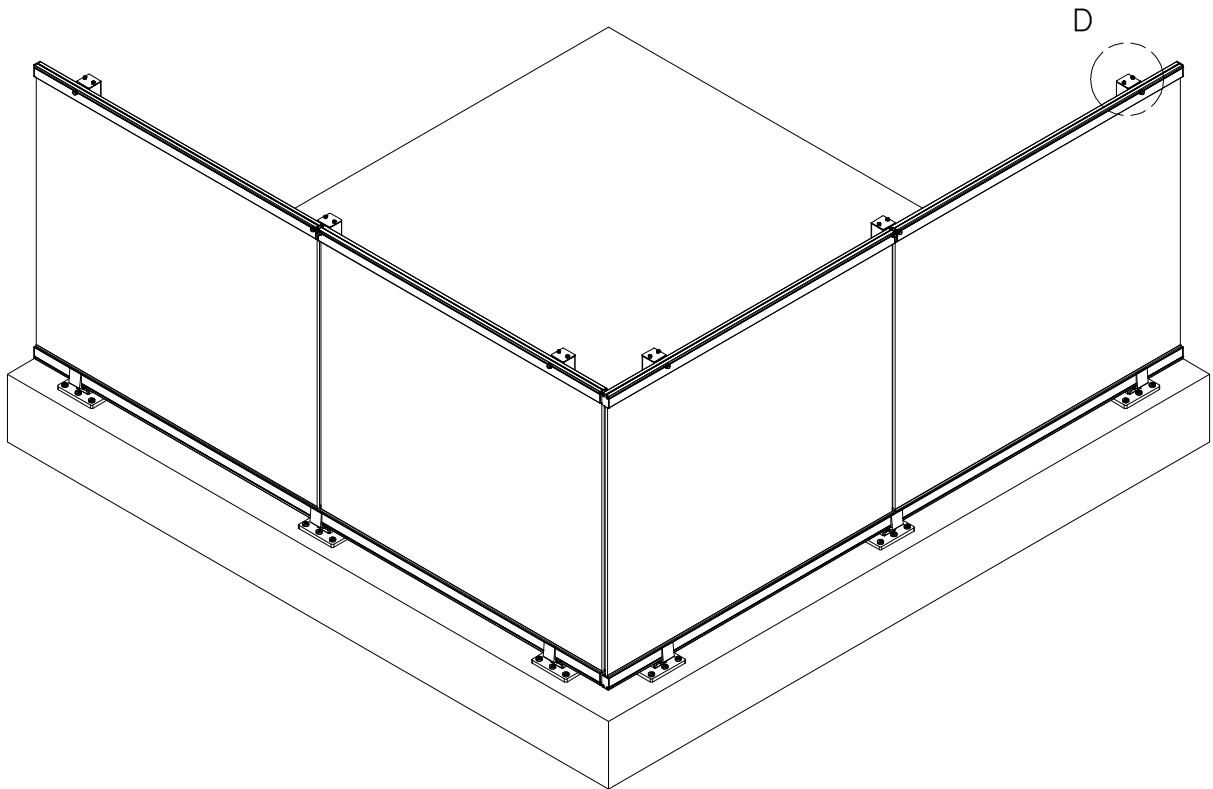
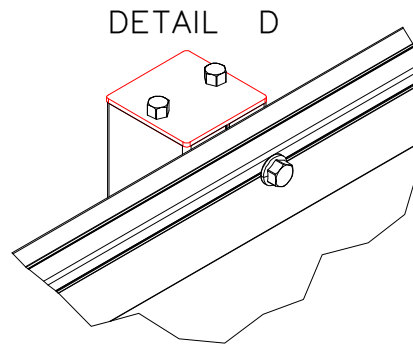

STEP 7. FINISH THE BALCONY ASSEMBLY

Clean railing with microfiber cloth.

If any damage has occurred during installation to painted parts, repair paint with correct ral code can be used!

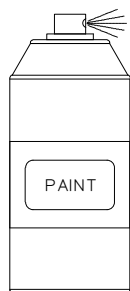
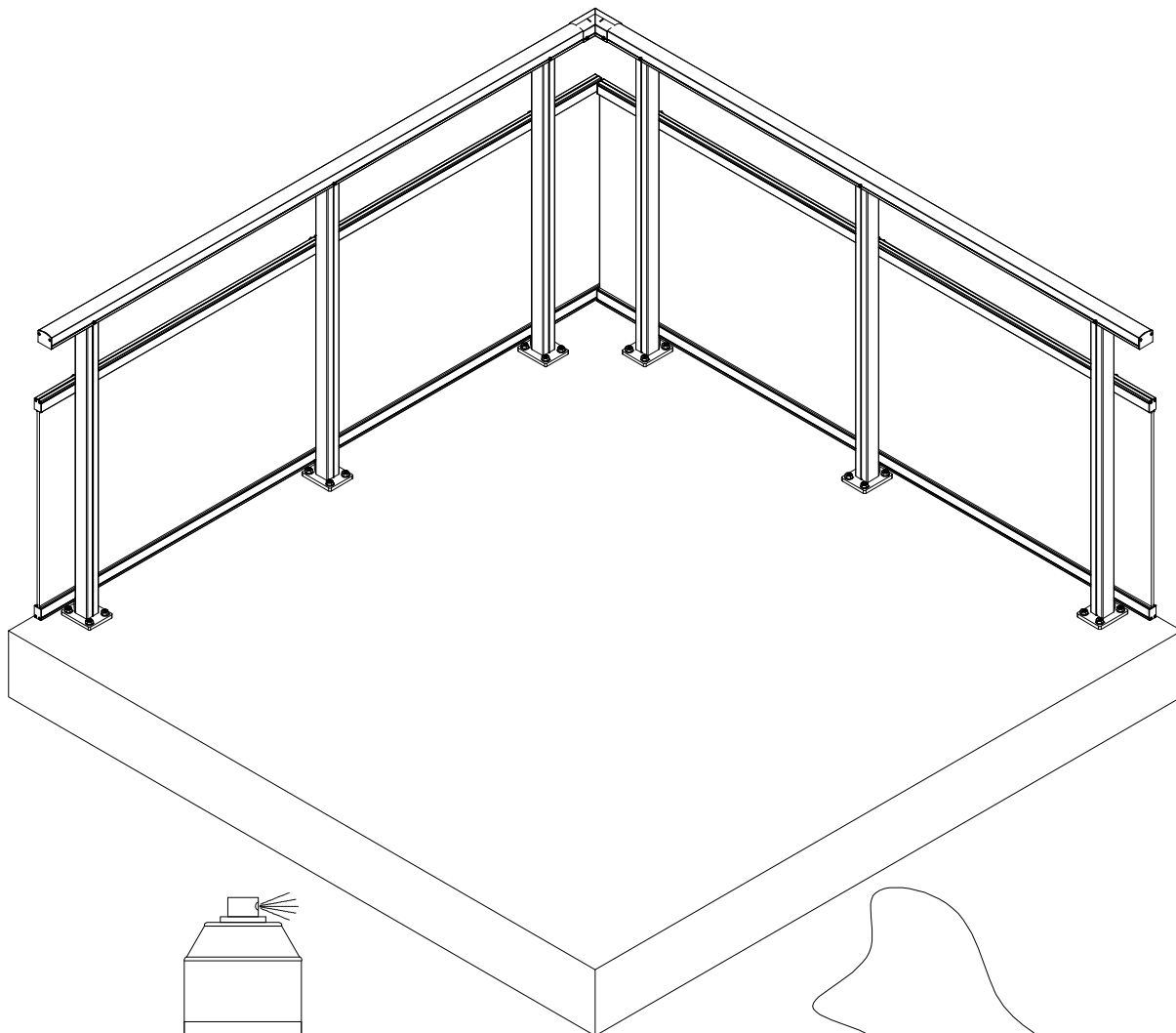

RE-PAIN T IF NEEDED

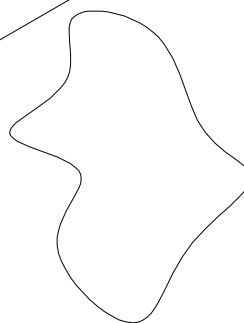

CLEAN THE ASSEMBLY

Enjoy your new Innore railing and stay safe!
Designed for safety, built to last.

Thank you for choosing Innore railing systems – Your Innore railing is designed and manufactured in Estonia with a focus on safety, durability, and timeless design.

Keep your railing in perfect condition:

- Clean regularly with mild detergent and water.
- Check fasteners and joints periodically.
- Avoid harsh chemicals or abrasive cleaners.
- Follow detailed steps in the Maintenance Guide.

For detailed information, see:

Maintenance Guide:

If you have any questions or need assistance, don't hesitate to contact us:

Email: info@innore.ee

Website: www.innore.eu

We're here to help you keep your railing safe, beautiful, and long-lasting.
Stay safe – and enjoy your view!

